

## Instructions

E87010-A0074-T003-A1-75XX

August, 2012  
Supersedes Issue of  
February, 2000

Contact Kit, Innova Controllers  
00, 0, 1, 1P, & 1<sup>3/4</sup>  
Class 14, 22, 30, 40, & 43  
Cat No 75AF14 thru 75EF14

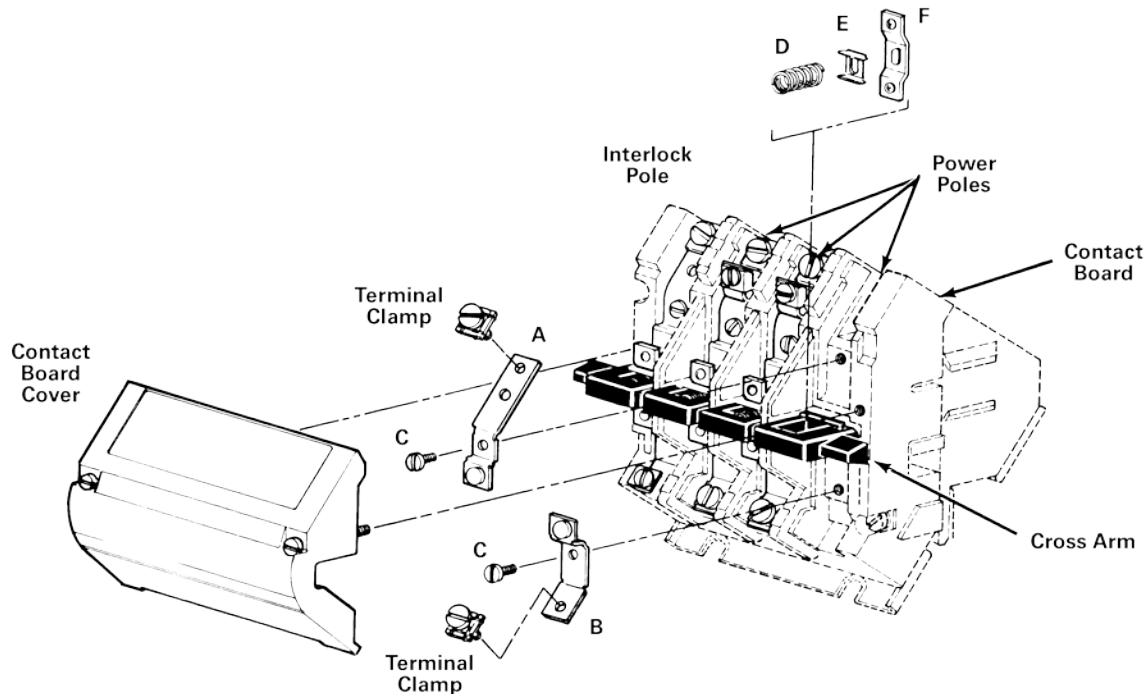

### KIT DATA

Use with sizes 00 through 1<sup>3/4</sup> Innova series controllers. Each kit catalog number applies to specific controller sizes as follows:

Catalog Number	Contact Kit for	Innova Series Size
75AF14	Interlock Pole	00, 0, 1, 1P, 1 <sup>3/4</sup>
75BF14	Power Pole	00
75CF14	Power Pole	0
75DF14	Power Pole	1
75EF14	Power Pole	1P, 1 <sup>3/4</sup>

Rating: The contact assumes the rating of the control on which the contact is mounted.

Contents of kits: Each kit contains the following:

- 1 **A** line side stationary contact
- 1 **B** load side stationary contact
- 2 **C** self-tapping screws
- 1 **D** spring
- 1 **E** spring retainer for kits 75AF14, 75BF14, and 75CF14 only
- 1 **F** movable bar

	<h3>WARNING</h3>
	<p>Hazardous voltage. Can cause death, serious personal injury, or property damage. Disconnect power before working on this equipment.</p>

### CONTACT REPLACEMENT

When one power pole requires contact replacement, replacing the contacts on all power poles of the controller is recommended to assure proper contact mating.

#### Disassembly

1. Remove the contact board cover from the controller.
2. For a controller equipped with an overload relay, the overload relay must be removed when replacing power pole contacts. For interlock pole contact replacement, removing the overload relay is not required.
  - a. Tag and remove wires from the overload relay load terminals.
  - b. The overload relay mounting plate is secured to the enclosure or mounting panel with one or two screws; remove screw(s).
  - c. Loosen the three screws at the contactor load terminals. A slot in the overload relay mounting plate engages a tab on the contactor mounting plate. Tilt the overload relay slightly to disengage the slot from the tab and pull the overload relay from the contactor.
3. Tag and remove wires at the contactor line and load terminals for the pole being repaired. Do not remove wires from a lug. Remove the terminal clamps, line lug or load side power take off lug, as applicable. Retain the terminal parts and screws.

(For Engineering Reference Only - Rev. D)

Disassembly - Continued

4. The movable contact bar includes a raised area in the center for spring seating or for aligning the spring retainer. Remove and discard the worn movable contact bar, spring and spring retainer observing the following:
  - a. For contact without a spring retainer, compress the spring and remove it from the cross arm. Remove the movable contact bar.
  - b. For contact with a spring retainer, pry the spring retainer away from the movable contact bar and slide the bar from the cross arm. Compress the spring against the spring retainer (toward the contact board) and tip the spring out of the cross arm. Remove the spring retainer from the cross arm.
5. Remove the worn line side stationary contact from the contact board by partially backing out the self-tapping screw that secures the contact. Keep the screw in the contact to avoid any problems that losing the screw in the equipment might cause. If the worn contact includes a line side power take off lug, remove the lug from the contact and install the lug on the new line side contact. Discard the worn contact.
6. Remove the worn load side stationary contact from the contact board as in step 5 above. Discard the contact.

<b>CAUTION</b>
The interlock pole contact kit is not interchangeable with the power pole contact kit. Using an interlock pole contact on a power pole will result in damage to the controller.

1. Secure the load side stationary contact **B** to the contact board with self-tapping screw **C**. The contact mounting hole is sized for the screw.
2. Secure the line side stationary contact **A** to the contact board with self-tapping screw **C**.
3. Install movable contact bar **F** observing the following:
  - a. For contact without a spring retainer, install the movable contact bar **F** in the cross arm. Compress spring **D** and, while holding the movable contact bar toward the stationary contacts, insert the spring in the cross arm.
  - b. For contact with a spring retainer, insert spring retainer **E** in the cross arm with the retainer edges facing away from the contact board as shown in the illustration. Compress spring **D** with tweezers or similar tool. While holding spring retainer **E** toward the contact board side of the cross arm, insert spring **D** in the cross arm. Compress the spring with the spring retainer and slide the properly oriented movable contact bar **F** into the cross arm.
4. Manually operate the controller cross arm and check for proper spring seating and contact mating.
5. To assemble the overload relay to the contactor, reverse the removal procedures.
6. Secure the removed terminal clamps and lugs, as applicable, to the contactor line and load terminals. Connect any removed wires.
7. Secure the contact board cover to the controller.

**Reassembly**

Use all parts furnished in the kit. Factory recommended assembly torques are as follows:

Assembly Item	Minimum Torque (Inch-pounds)
Stationary contact mounting screw <b>C</b>	14
Power pole line and load terminal screws	18
Overload relay to enclosure or mounting panel mounting screw(s)	18